

Win the right work on the right terms

How AI is reshaping tendering and preconstruction.

volve

© Volve Technologies AS 2026

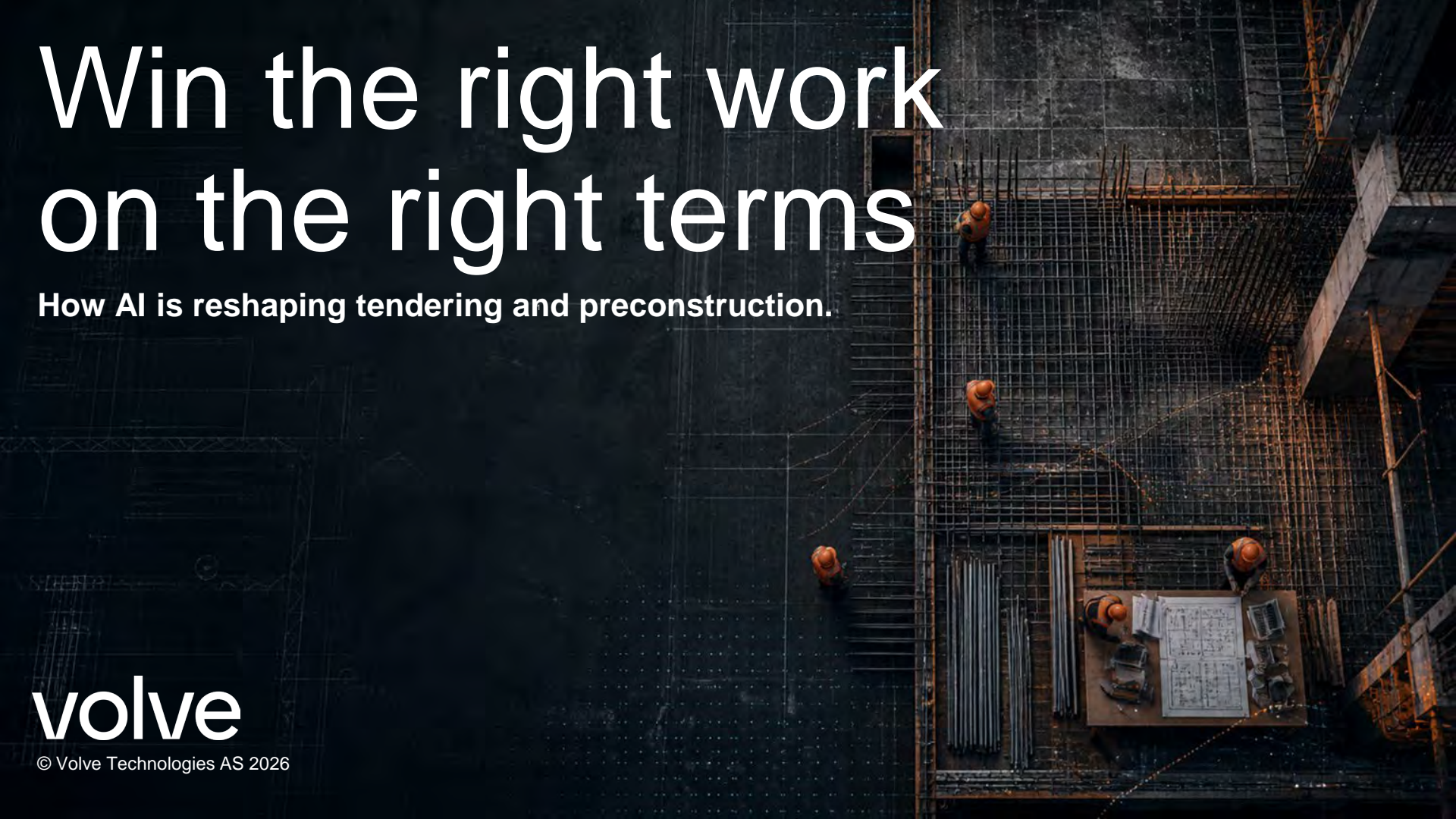

Project decisions live in complex sets of documents

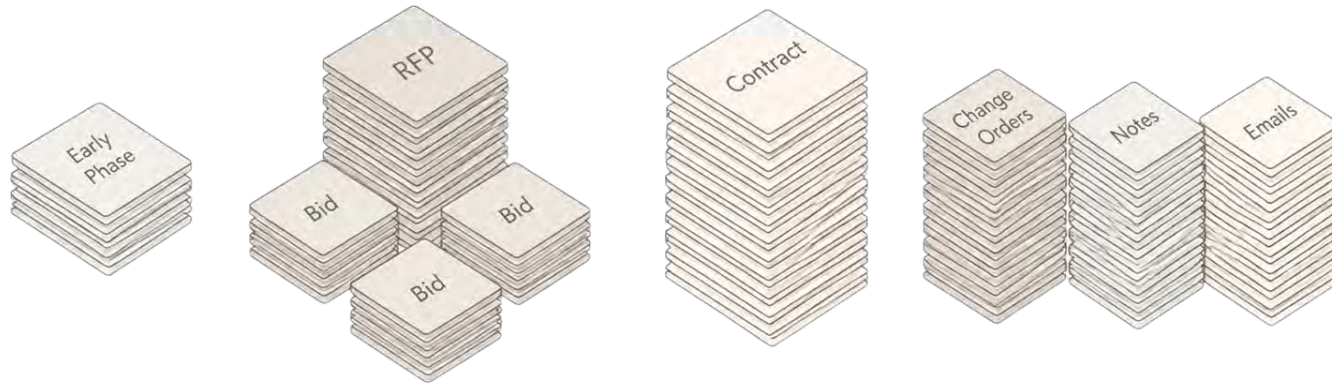

It is the ground truth.

For risk, scope, and cost. And for what's missing.

Three failure modes we see on every tender

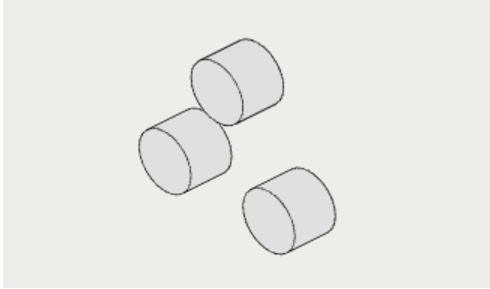

Manual review at scale

Time-pressured human reading misses requirements, contradictions, and gaps.

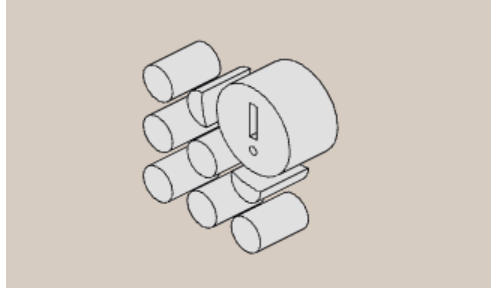

No structured visibility

Risks, obligations, and scope live in PDFs and people's heads. Leadership can't see what's been committed to until something goes wrong.

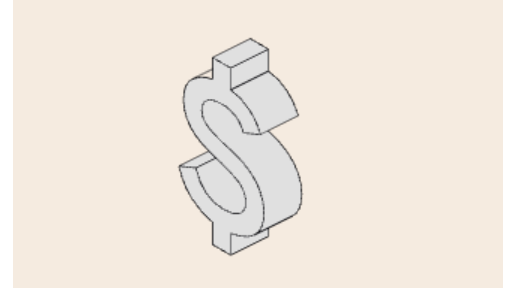

Generic AI isn't review-safe

ChatGPT-style tools hallucinate, lose hierarchy, and can't trace answers to source. In a contractual setting, that's a non-starter.

From generic chatbots to construction -native AI

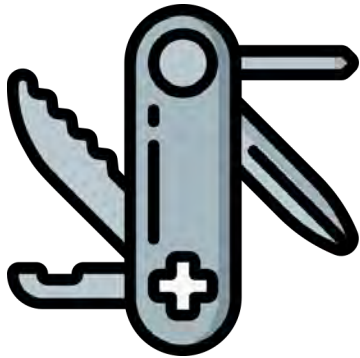

GENERIC AI



CONSTRUCTION-NATIVE AI

As workflow complexity increases, vertical AI compounds relative to horizontal AI

As workflows become more connected, repeatable, and business-critical, consistency, context, and governance become more important. That is where generic AI becomes less sufficient and Volve becomes more valuable.

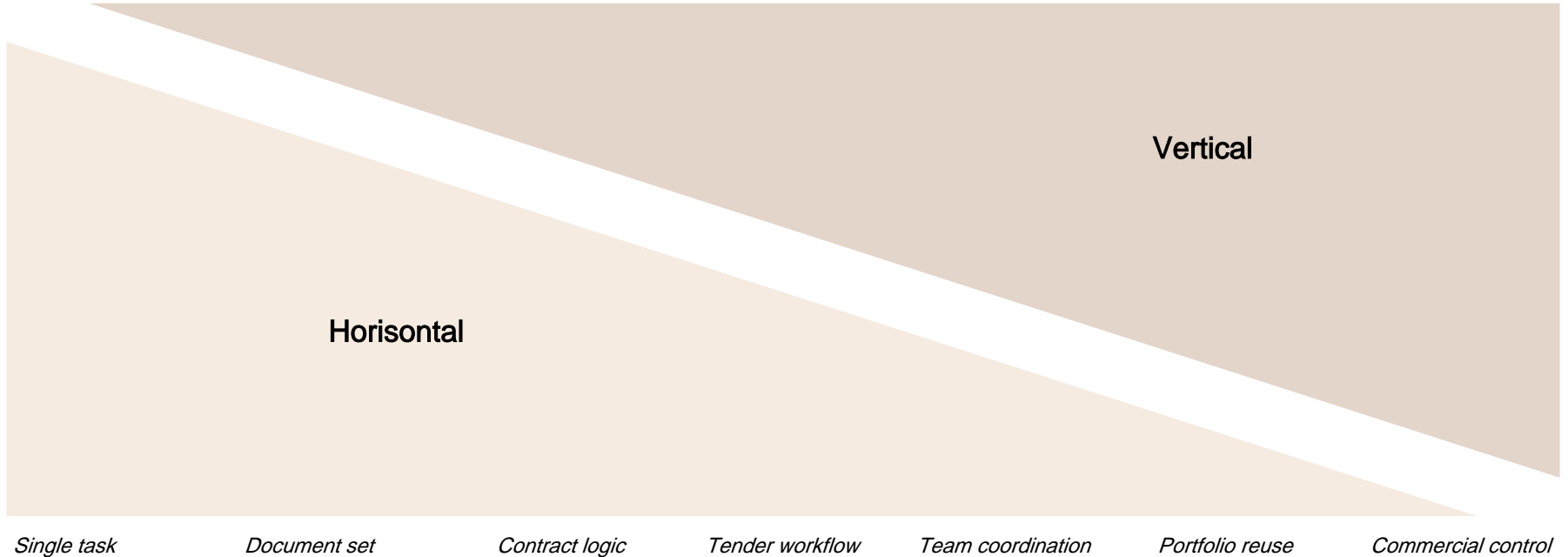

Volve turns complex tender, contract, and project documentation into defensible decisions.

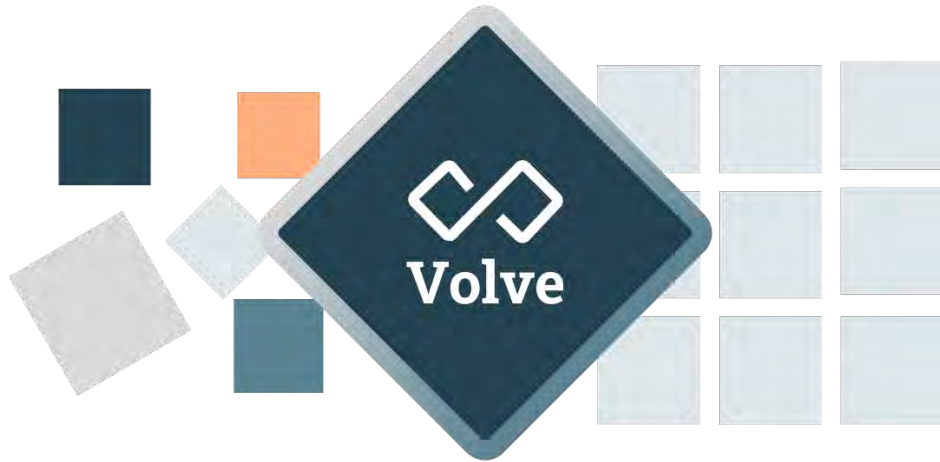

Handles the complexity

Built-in industry knowledge

Traceable and controlled

Secure

Improves with every project

AI Built for tendering and pre-construction

Better risk management

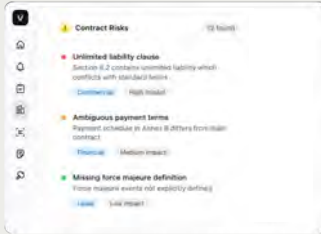

Surface commercial and contractual risks before commitment

Identify obligations, deviations, and gaps before they become downstream issues

Higher bid quality, consistently

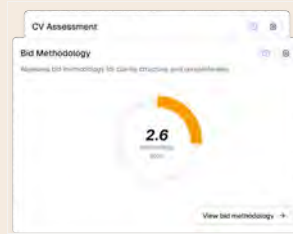

Draft stronger bids before submission

Navigate tender and contract material with better structure and visibility

Scope and claim control



Claim building and commercial control

Support more consistent workflows across projects and geographies

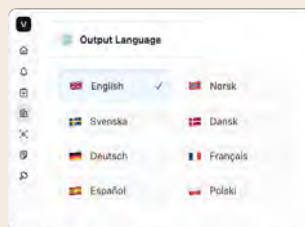

With Volve

For go/no-go:

123 docs and **4,200-page** tender package reviewed

17 red flag -risk items flagged with linked source references

For bid development:

3 bid assumptions corrected before submission

4 bid quality -assurance rounds executed before delivery

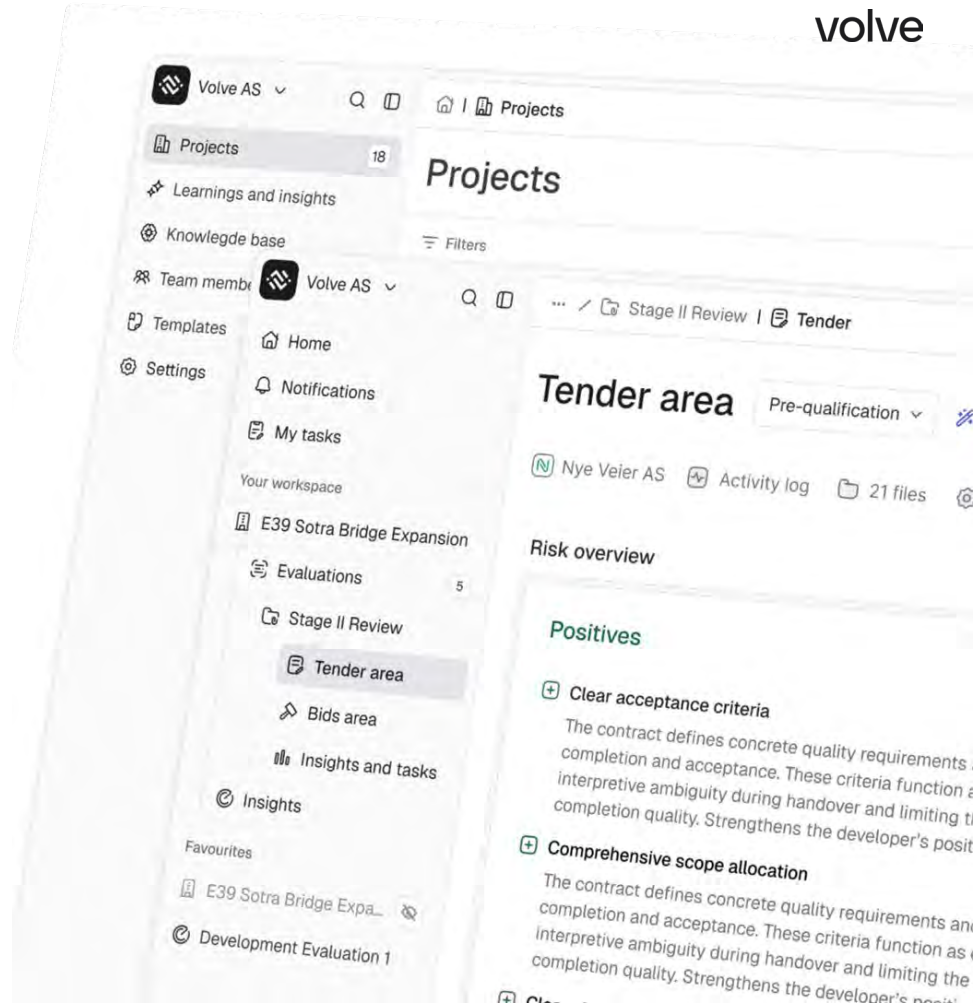

Use case 1

Surface commercial and contractual risks before you sign

Find risks based on your own risk tolerance and let Volve flag red lines

Every risk linked back to the source clause for peer review

Severity scored against the contractor's own standards and playbook

Risks exported into the existing tender risk register

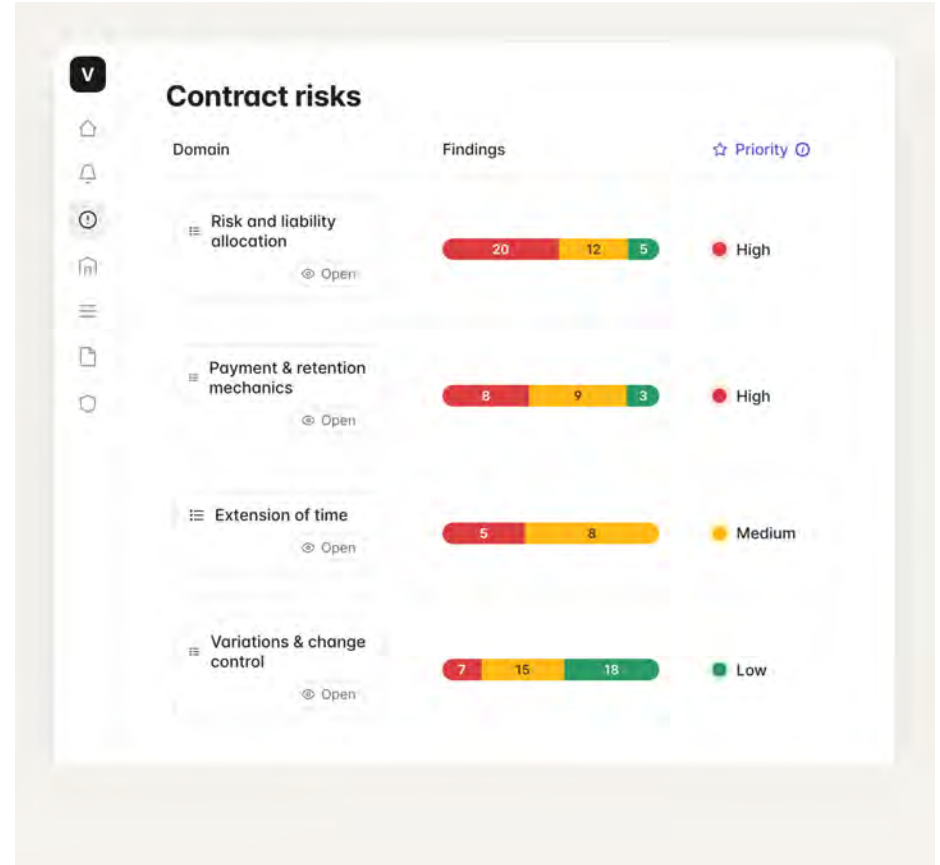

Find scope and obligations

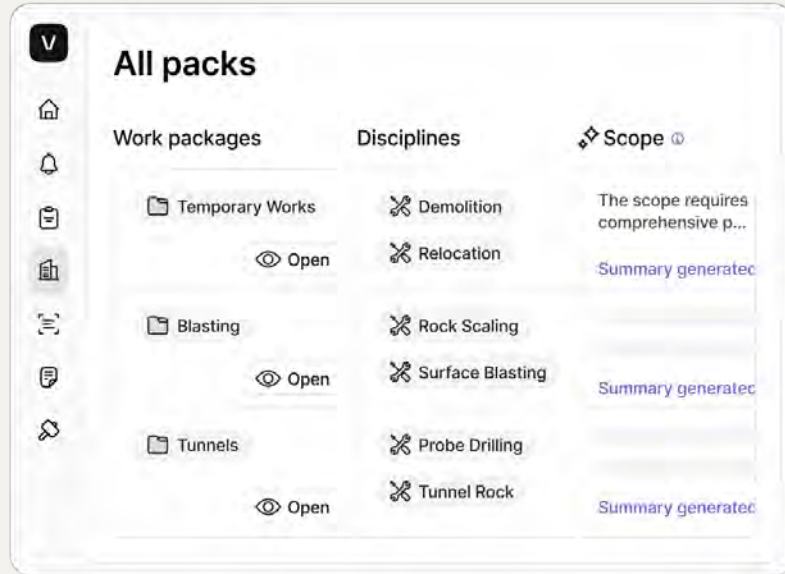

Know what you're committing to across thousands of pages.

Scope mapped by work package and discipline

Obligations register with notice periods and time-bar dates

Deviations from the contractor's standards highlighted upfront

Bid coverage and quality assessment

Submit knowing nothing slipped through.

Every deliverable connected to the RFP criteria

Methodology and CVs scored against the actual evaluation criteria that learns from clients

Drafts produced against criteria based in historical project references

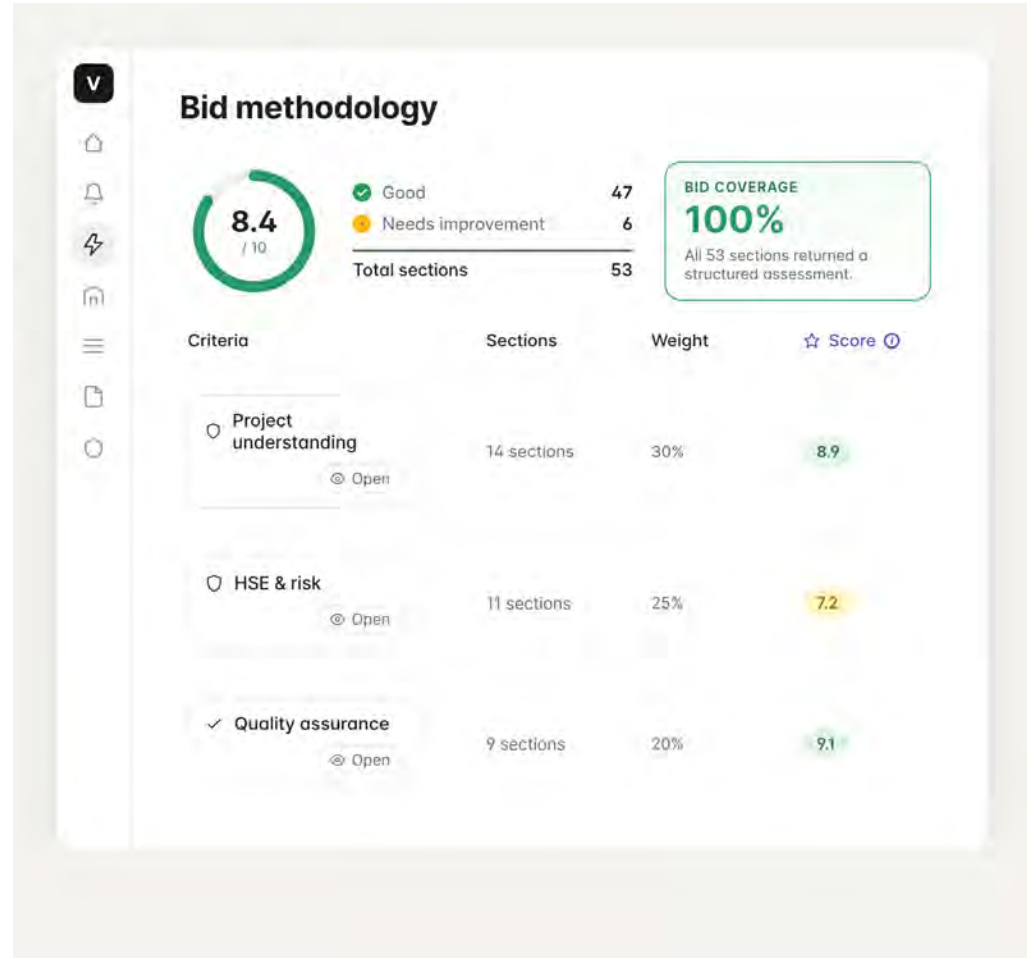

Build on what you know

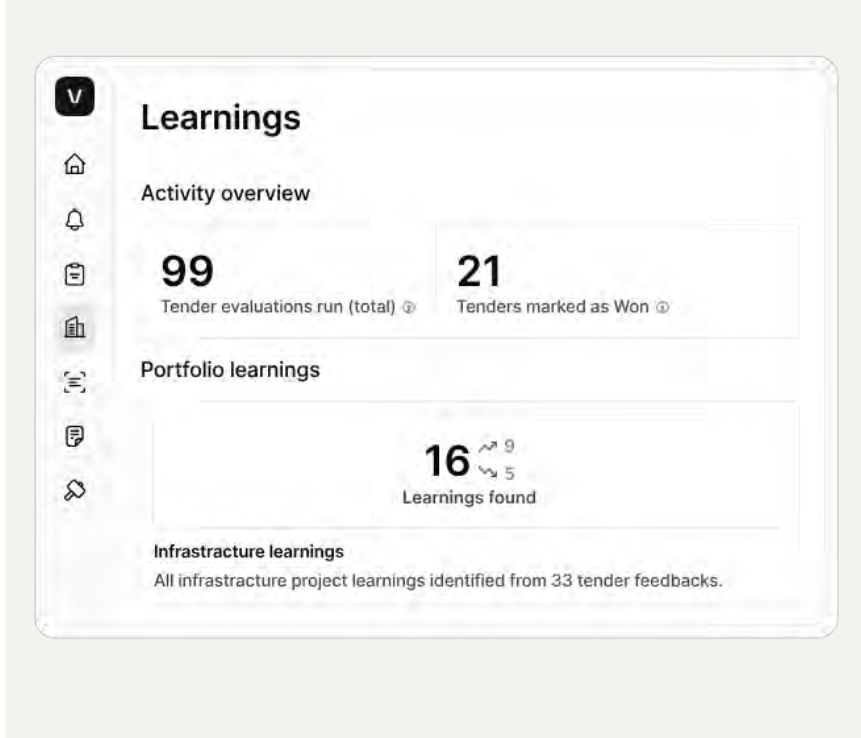

Lessons from past tenders usually live in people's heads

Volve captures them so they don't happen again

Each bid builds on what the team learned, the feedback they got and not just what they wrote



2,000+ tenders and contracts run through Volve

Control the risk

60% more time for early risk mitigation and optimisation.

Win more bids

Large infra customer achieved 100% bid quality scores from public evaluators across five consecutive wins.

Remove rework

30% less rework from clearer scope and earlier visibility.

Thank you!



Alf Jørgen Dovland
Co-founder & COO
Alf@volvetechnology.com

